

Area and dimensions are 'or thereby' and are subject to topographical survey and confirmation of title



1. All sizes to be checked on site prior to construction.
2. This drawing is the copyright of the author.

INDICATIVE: FOR ILLUSTRATIVE PURPOSES ONLY

Site Layout Plan	
Store Name	Easter Road, Edinburgh
Sales Area (sqm)	c.842
G.I.A. (sqm)	c.1,188
Site Area (sqm)	2,476
Total Car Parking	28
Scale	1:100 @ A1

smith design associates

16 Lynedoch Crescent, Glasgow G3 6EQ
T - 0141 353 3501
glasgow@smithdesign.co.uk
www.smithdesign.co.uk

client
Lidl UK GmbH

project
Proposed Retail Unit,
Easter Road, Edinburgh

drawing
Proposed
Floor Plan

scale
1/100 @ A1

date
16.09.13

status
PRELIMINARY

job no.
G1700-99

drawing no.
P103

revision
-

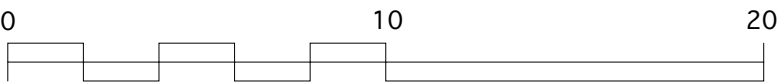
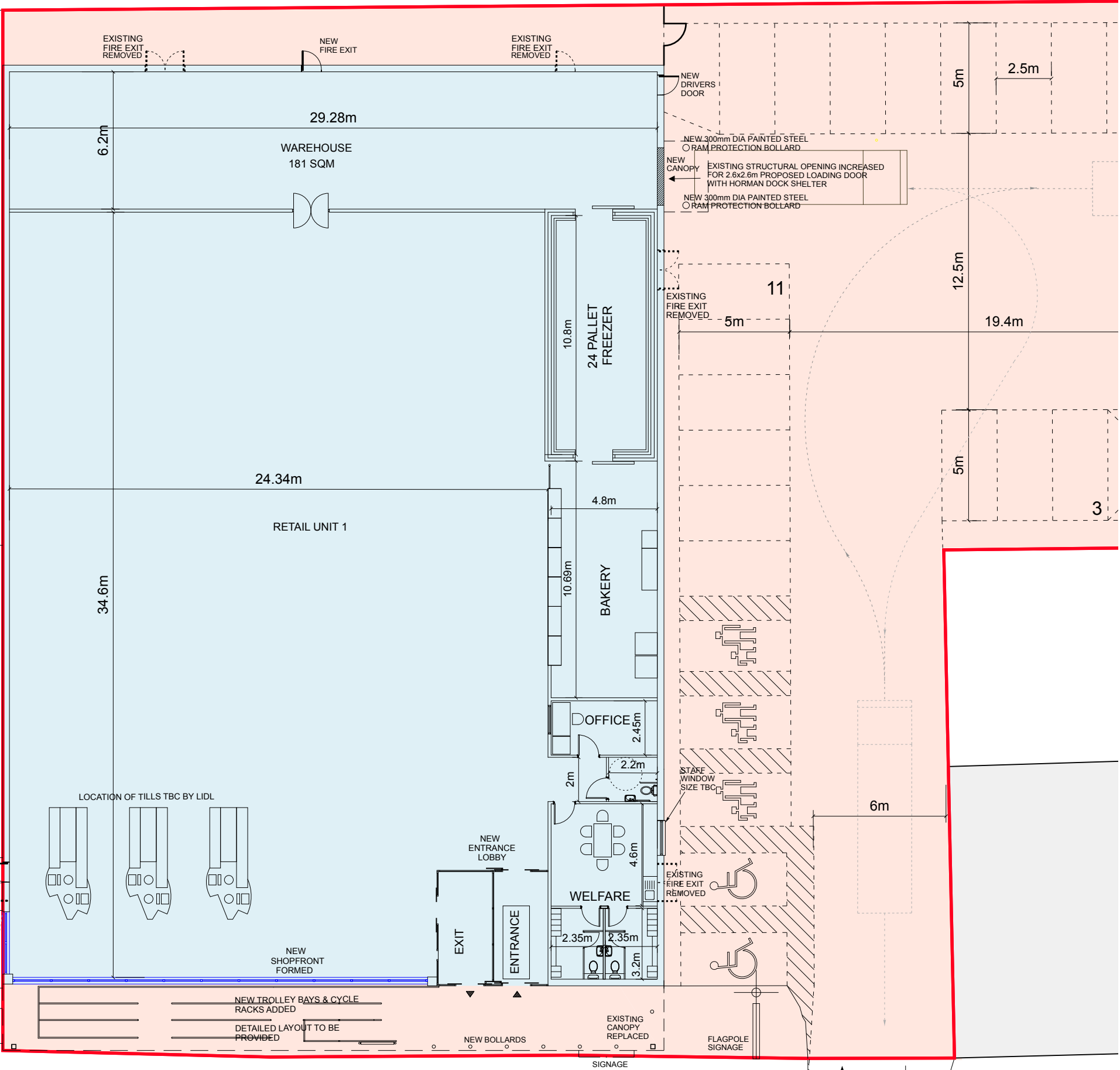

EASTER ROAD

ACCESS EGRESS

DRAFT-04